

October 29, 2021

Tree Assessment – Geyer Road Improvements

Background and Scope: The City of Frontenac is planning updates to Geyer Road south of Clayton Road that include sidewalk installation and storm water improvements. The subject area contains landscape trees that may be impacted by the proposed work. The City requested information about the location, species, size, and condition of trees in the subject area. While there are multiple scenarios of work being discussed (sidewalk location, extent of stormwater work), this report provides a preliminary assessment of trees to the extent requested by the City.

Documents: This report includes the following documents.

- **Tree Map A** - A map utilizing a geo-referenced aerial photograph with approximate tree locations shown.
- **Tree Data Table** – A list of trees in the subject area along the west side of Geyer Road. The list contains the following data:
 - Tree Number
 - Species – Common Name
 - Condition Rating (Excellent, Good, Fair, Poor, Critical, Dead)
 - DBH – Trunk diameter at 4.5 feet above ground
 - Distance from existing curb – in feet
 - Tree Comments
- **Tree Map B** – A map of tree locations and tree numbers from the tree data table. This map consists of tree numbers added to segments from an engineered drawing that includes five pages of a set produced by Lochmueller Group dated 4-21-2021.

Findings: Individual trees on the west side of Geyer in the subject area were numbered and assessed and included in the three documents identified above. A total of 41 trees were assessed along the west side. There are 20 trees within the estimated work zone, and 20 that are outside of the estimated work zone, but have issues such as a lean, critical health, etc.

If the sidewalk was located on the west side of Geyer, there are 9 suggested tree removals based on project needs and 5 trees that are suggested for removal regardless of project needs. These five trees are in poor health or are probable failures from lean, poor root structure, etc.) There are 25 trees that will need additional assessment as construction specifications are developed. There is also one tree stump and 1 tree that will need limb pruning. A group of spruce trees near the southwest corner of Clayton-Geyer will likely need some limb pruning as well.

A preliminary assessment of trees along the east side of Geyer indicates very few trees that would be impacted by sidewalk construction. However, there are several areas of honeysuckle and other invasive shrubbery that would be affected. This vegetation provides screening, albeit from an exotic and invasive plant species. Accommodations for pruning or removing this vegetation will be required.

There are some areas along the eastern route where removal of the honeysuckle will greatly exaggerate views of larger trees (white pines, etc) that have been pruned for utility clearance in the past. The shrubby vegetation provides a bit of a visual buffer to the upper canopies of these pine trees. While fewer trees may be impacted along the eastern route, consideration should be given to potential impacts to this lower vegetation and the resulting views and future maintenance of any replacement plants that may be considered.

Respectfully submitted,



Skip Kincaid
Director of Urban Forestry
ISA Board Certified Master Arborist MW-0155BM
ISA Tree Risk Assessment Qualified
SAF Certified Forester #1516
TCIA – Certified Tree Care Safety Professional (CTSP)
TCIA – Crew Leader Certified

TREE MAP – West side of Geyer; South of Clayton Road



TREE MAP – West side of Geyer; South of Clayton Road



GEYER ROAD - WEST SIDE TREES (10/24/21)

TREE #	Common Name	Condition	DBH	Feet from XST Curb	Tree Comments
1	redbud	Fair	10	8	Prune 6" limb
3	stump	Dead	20	12	20' tall stump dead. Honeysuckle along road
4	pine eastern white	Critical	16	12	Severe lean toward road. Soil lift.
5	pine eastern white	Critical	22	20	Severe lean to south. Soil lift. Leaning on adjacent tree.
6	pine eastern white	Fair	12	15	Lean to south. Adjacent leaner pushing it.
7	mulberry	Fair	22	9	multiple stems
8	oak post	Fair	24	7	Lean away from road. To west. Basal damage with woundwood. Basal decay likely.
9	maple silver	Fair	34	5	Evidence of past pruning of large limbs pruned towards road. Crown dieback.
10	hackberry	Good	16	14	
11	oak shingle	Fair	20	7	
12	elm slippery	Good	20	7	multiple trunk
29	pine eastern white	Fair	8	14	
13	elm slippery	Fair	28	14	
14	redbud	Fair	8	11	
15	elm slippery	Fair	26	15	Lg limbs pruned in past. Lean toward road.
16	ash green	Critical	8	8	Severe dieback and lean.
17	hackberry	Poor	20	12	Severe dieback. Mechanical damage.
18a	pine eastern white	Fair	14	12	Group (18a thru 18d) of white pine and hemlock (10-18" diam) outside of proposed excavation. Some w lean.
18b	pine eastern white	Fair	14	12	Group (18a thru 18d) of white pine and hemlock (10-18" diam) outside of proposed excavation. Some w lean.
18c	pine eastern white	Fair	14	12	Group (18a thru 18d) of white pine and hemlock (10-18" diam) outside of proposed excavation. Some w lean.
18d	pine eastern white	Fair	14	12	Group (18a thru 18d) of white pine and hemlock (10-18" diam) outside of proposed excavation. Some w lean.
19a	pine eastern white	Fair	14	9	Group of (19a thru 19j) white pine outside of proposed excavation. Some w lean.
19b	pine eastern white	Fair	14	9	Group of (19a thru 19j) white pine outside of proposed excavation. Some w lean.
19c	pine eastern white	Fair	14	9	Group of (19a thru 19j) white pine outside of proposed excavation. Some w lean.
19d	pine eastern white	Fair	14	9	Group of (19a thru 19j) white pine outside of proposed excavation. Some w lean.
19e	pine eastern white	Fair	14	9	Group of (19a thru 19j) white pine outside of proposed excavation. Some w lean.
19f	pine eastern white	Fair	14	9	Group of (19a thru 19j) white pine outside of proposed excavation. Some w lean.

TREE #	Common Name	Condition	DBH	Feet from XST Curb	Tree Comments
19g	pine eastern white	Fair	14	9	Group of (19a thru 19j) white pine outside of proposed excavation. Some w lean.
19h	pine eastern white	Fair	14	9	Group of (19a thru 19j) white pine outside of proposed excavation. Some w lean.
19i	pine eastern white	Fair	14	9	Group of (19a thru 19j) white pine outside of proposed excavation. Some w lean.
19j	pine eastern white	Fair	14	9	Group of (19a thru 19j) white pine outside of proposed excavation. Some w lean.
20	maple silver	Fair	16	3	Crown Dieback
21	maple silver	Fair	12	5	Prior maple removals in this row. Crown dieback.
22	maple silver	Fair	18	5	Crown Dieback
26	redbud	Fair	10	9	Downslope. Fair-poor condition. Fill needed will require removal
27a	hackberry	Fair	14	12	4-5 (8-18" diam) hackberry at drainage. May need to be removed for storm water work. 8-15' from curb
27b	hackberry	Fair	14	12	4-5 (8-18" diam) hackberry at drainage. May need to be removed for storm water work. 8-15' from curb
27c	hackberry	Fair	14	12	4-5 (8-18" diam) hackberry at drainage. May need to be removed for storm water work. 8-15' from curb
27d	hackberry	Fair	14	12	4-5 (8-18" diam) hackberry at drainage. May need to be removed for storm water work. 8-15' from curb
27e	hackberry	Fair	14	12	4-5 (8-18" diam) hackberry at drainage. May need to be removed for storm water work. 8-15' from curb
28	Juniper spp	Fair	14	12	

41 trees assessed total (inc one stump)
 20 trees within estimated work zone
 20 trees outside of estimated work zone, but have issues (lean, critical health, etc)

9	suggested removals based on project needs
25	reassess based on construction specifics
5	suggested removal regardless of project needs (poor health, probable failures from lean, etc)
1	stump (#3)
1	prune (#1)

TREE MAP B – West side of Geyer; South of Clayton Road

(Tree numbers added to segments from map produced by Lochmueller Group dated 4-21-2021)

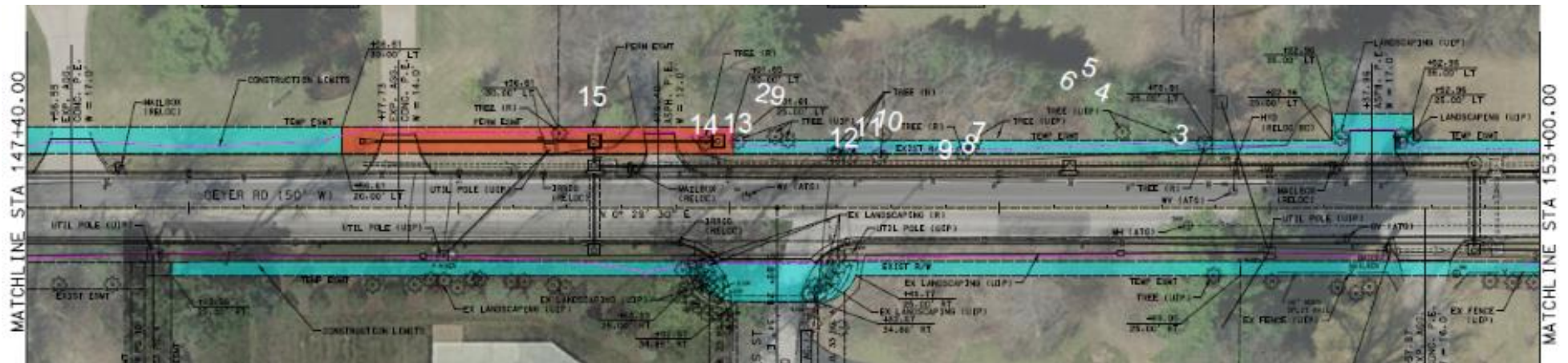
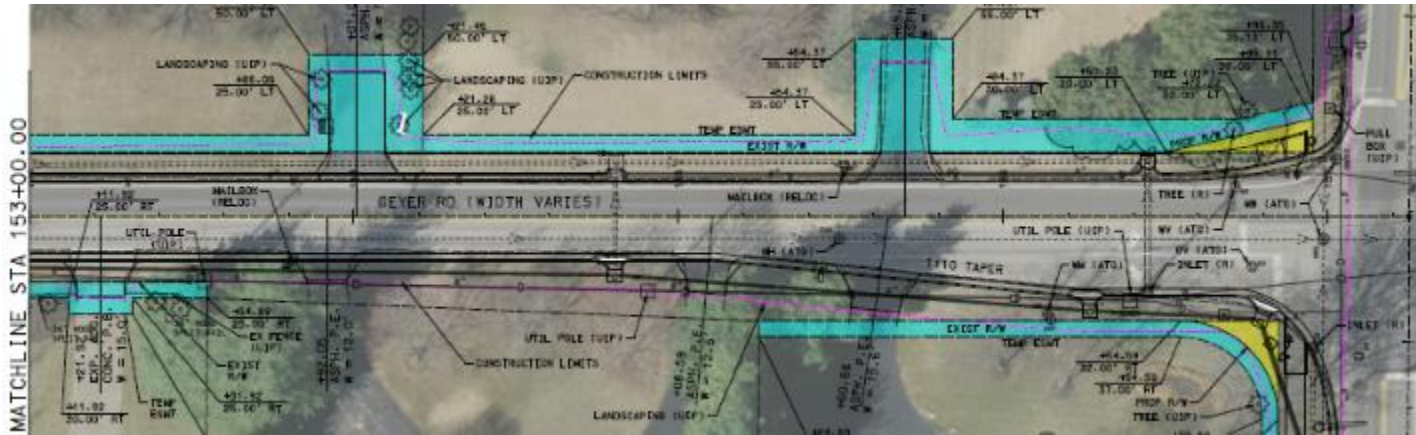

TREE MAP B – West side of Geyer; South of Clayton Road

(Tree numbers added to segments from map produced by Lochmueller Group dated 4-21-2021)

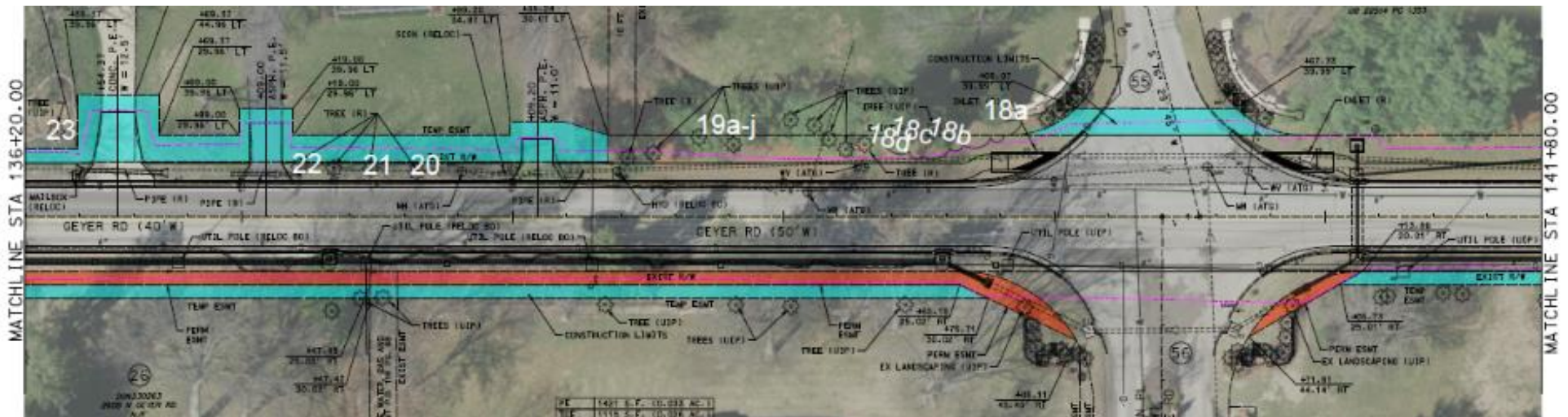
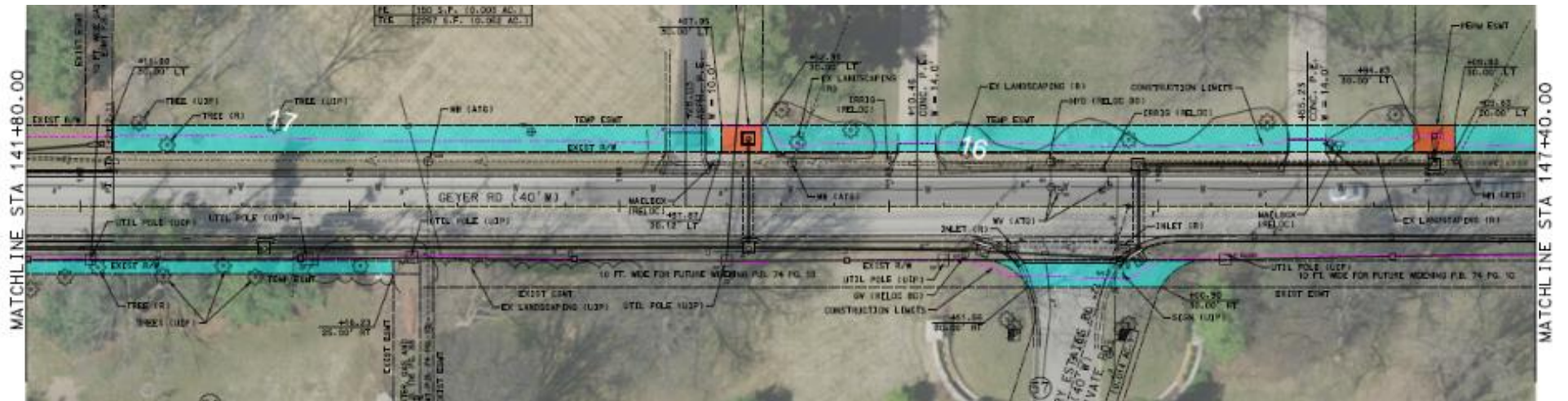

TREE MAP B – West side of Geyer; South of Clayton Road

(Tree numbers added to segments from map produced by Lochmueller Group dated 4-21-2021)

